

Instruction Manual

TMO-MED-027

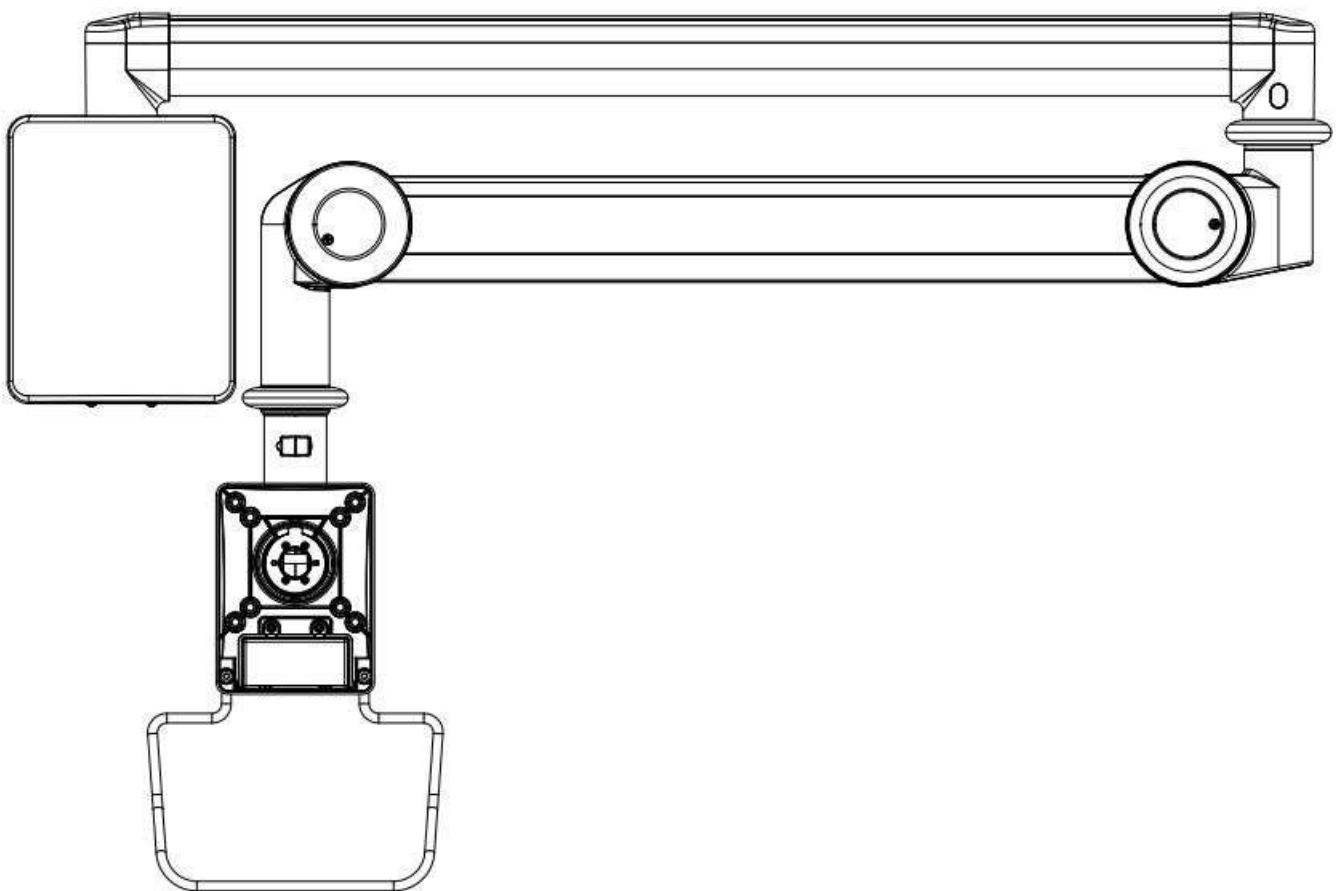

Installation Guide

Please take some time to read this installation guide and then follow this step for assembly. Do not discard any packaging until all parts and accessory packages have been checked. If you are missing any parts, contact the vendor you purchased from.

Accessories list	-----	3
Linear dimension drawing	-----	4
Rotate Dimension Linear Drawing	-----	5
Wall mount installation instructions	-----	6
Recommended height for wall mount installation	-----	7
Wall mount installation	-----	8
Bracket installation	-----	9
Accessory installation	-----	10
Rotation, pitch, and load-bearing adjustment	-----	11
Safety precautions	-----	12



Installation should be performed by a qualified technician and should comply with local regulations.

Accessories list

①

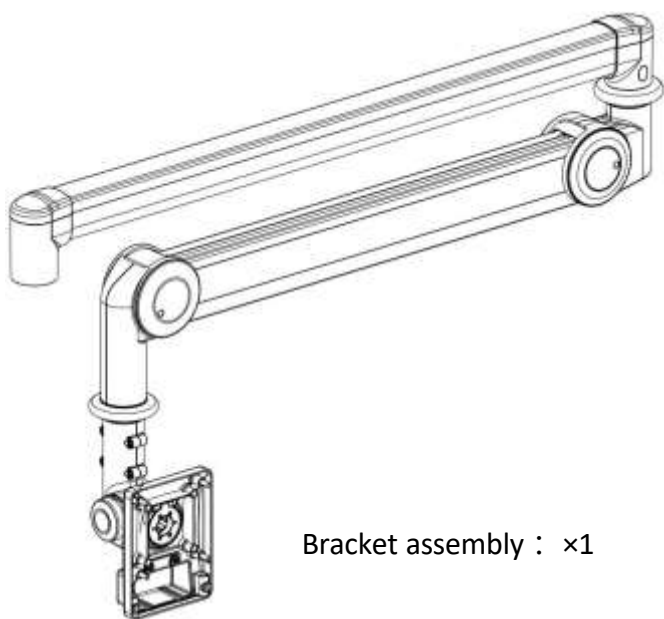

Bracket assembly : ×1

②



Wall mount base : ×1set

③



Base nylon pad : ×1pc

④

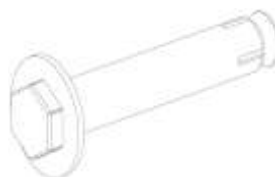

Internal expansion
hexagon screw :
M10*100×4set

⑤



lifting handle : ×1pc

⑨

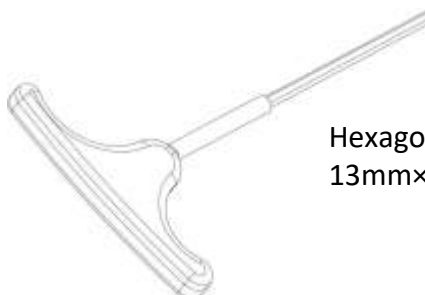

Hexagon wrench :
13mm×1pc

⑥



Handle locking screw :
M5*8×2pcs

⑦



Monitor fixing screws :
M6*25×4pcs

⑩



Hexagon wrench
: M8-13×2pcs

⑧



Hexagon socket
wrench : M6×1pc

⑪



Cross locking wrench :
×1pc

Linear Dimension Drawing

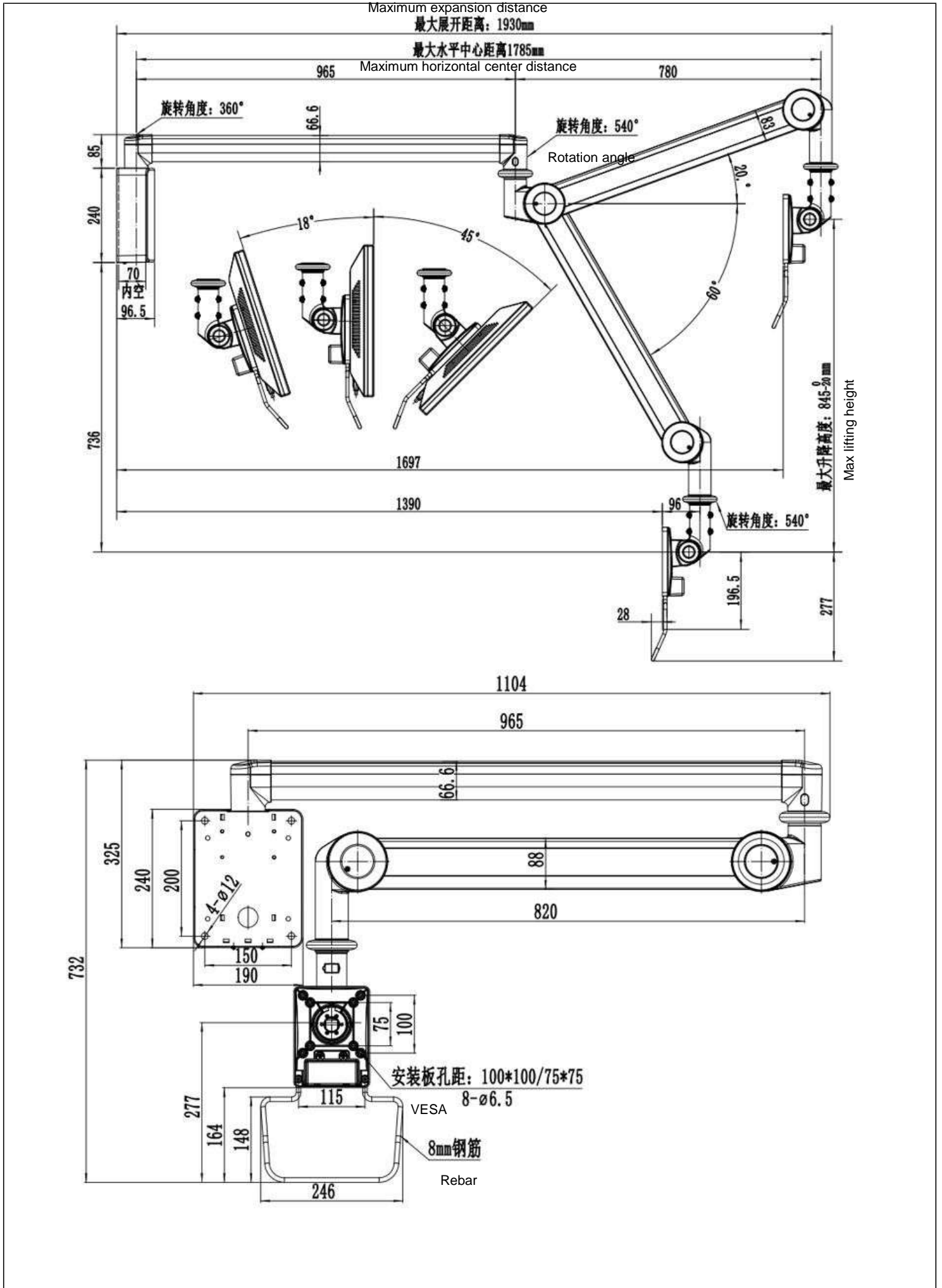

Rotate Dimension Linear Drawing

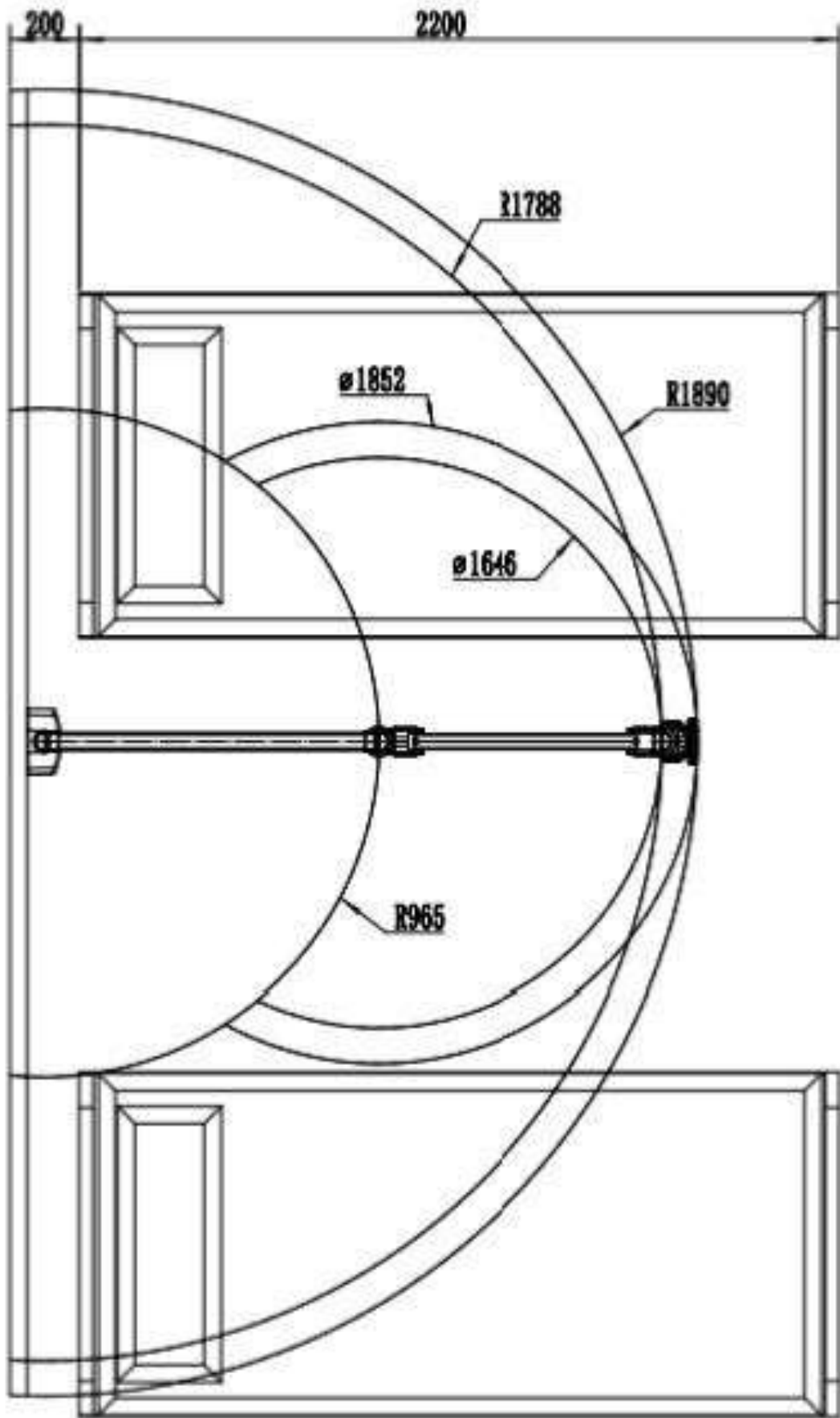

Unit: mm

Wall mount installation instructions

1. The pre-installation location must meet the specified requirements;

Wall requirements	Accessories use screws	Installation method
1. Concrete 2. Solid red brick wall 3. Solid cement brick	Stainless steel built-in hexagonal expansion screw (M10*100)	Punching diameter: $\phi 14$; Punching depth: 90mm; Drill bit: 14#;

2. The installation angle of the wall mount base, wall and ground must meet the requirements ;

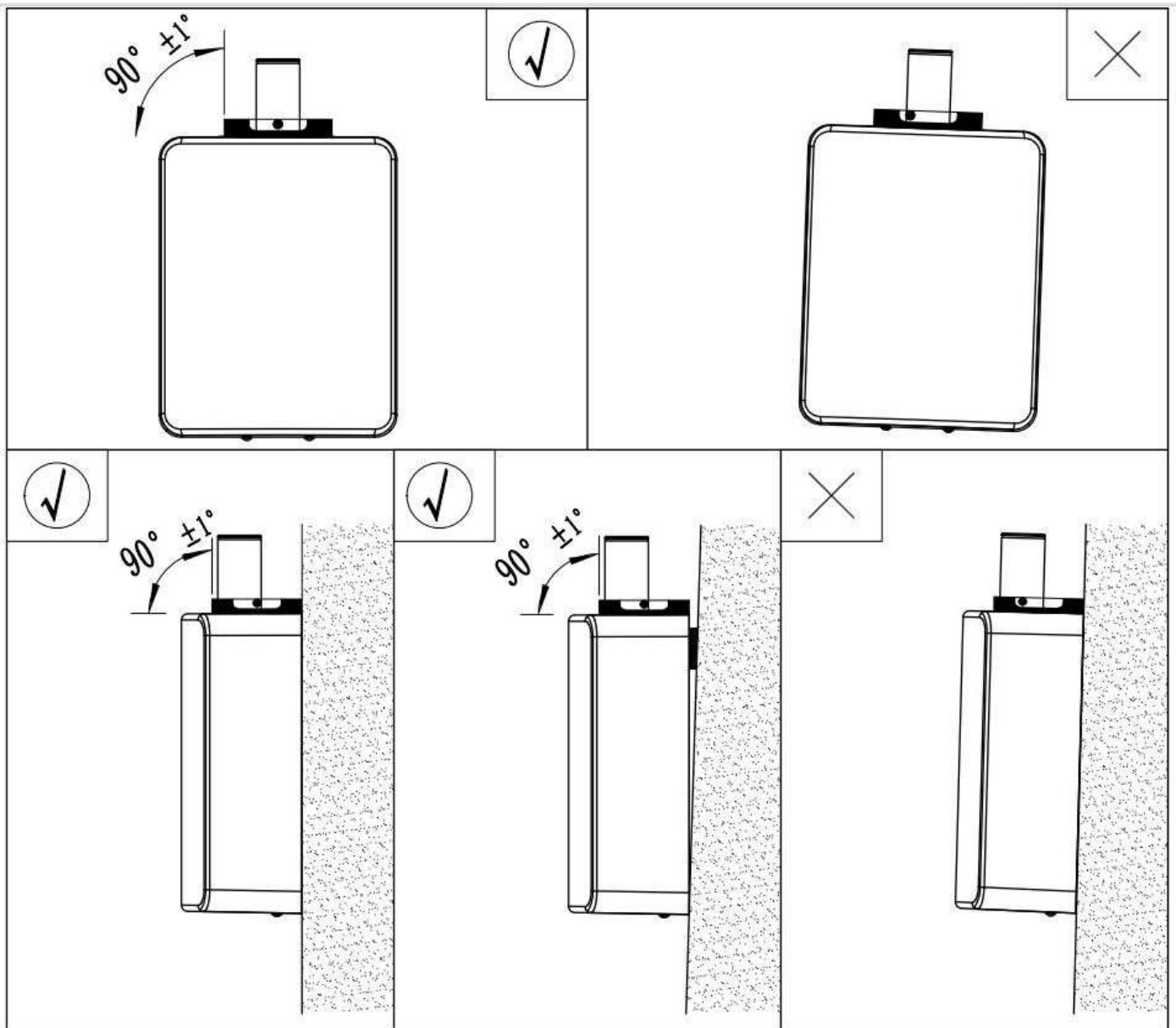

Recommended height for wall mount installation

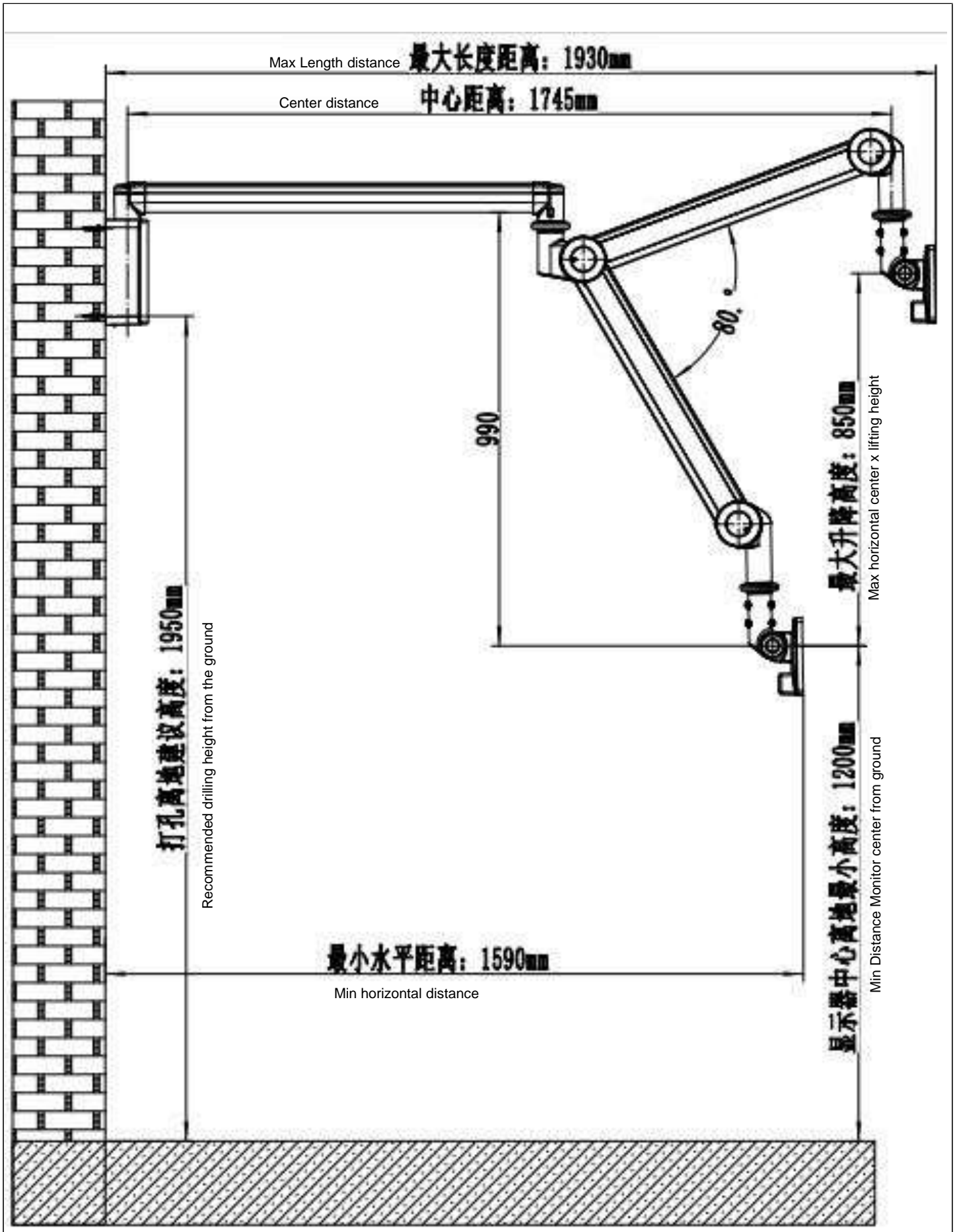

Wall mount installation

1. Take out the wall installation punching paper, make the horizontal paper and the ground as level as possible, then determine the punching position, and finally punch the specified embedded holes according to the installation instructions;

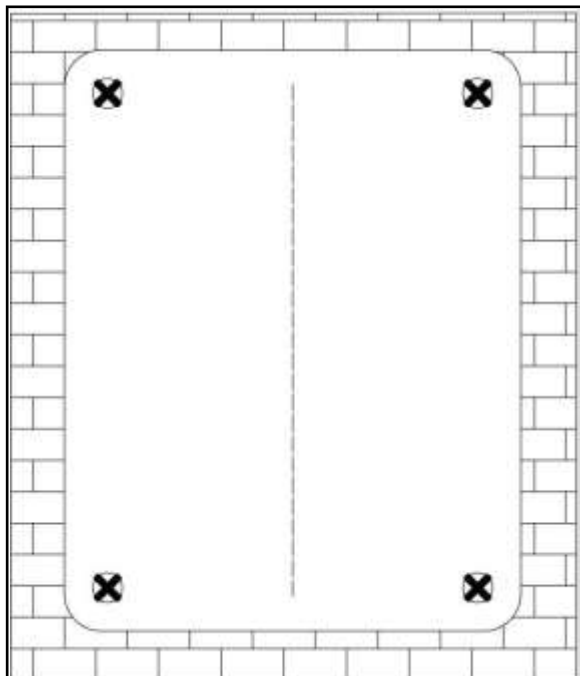

2. Unscrew the screws in the order shown in the diagram, lift the base cover upwards slightly, and then take out the base cover horizontally;

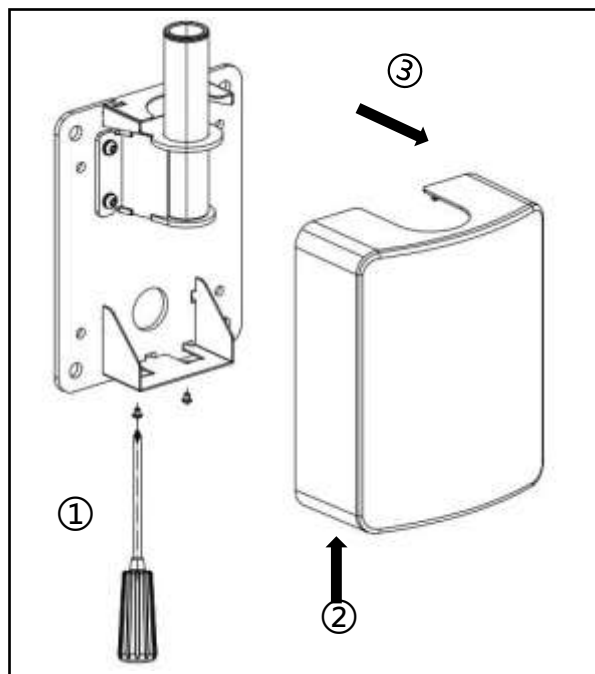

3. First nail the expansion nut into the embedded hole, then align the base hole with the embedded nut thickness, install the gasket and tighten the fixing screws in sequence;

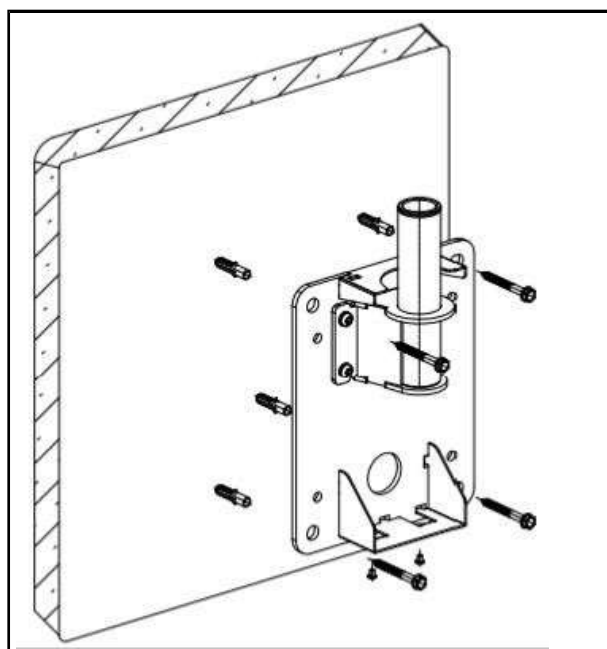

4. Loosen the bracket to fix the base, adjust the levelness of the base and the ground, and then tighten the fixing screws one by one.

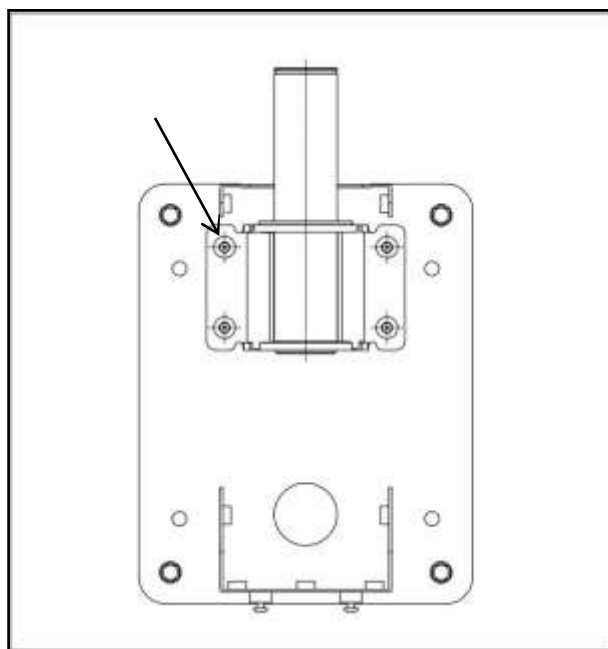

Bracket installation

1. Installation steps:

1. Put the base nylon gasket of the accessory package ③ into the base fixing shaft;
2. Insert the bracket assembly into the base fixing shaft as shown in the figure;
3. Fix the base decorative cover on the base from top to bottom, and then tighten the fixing screws.

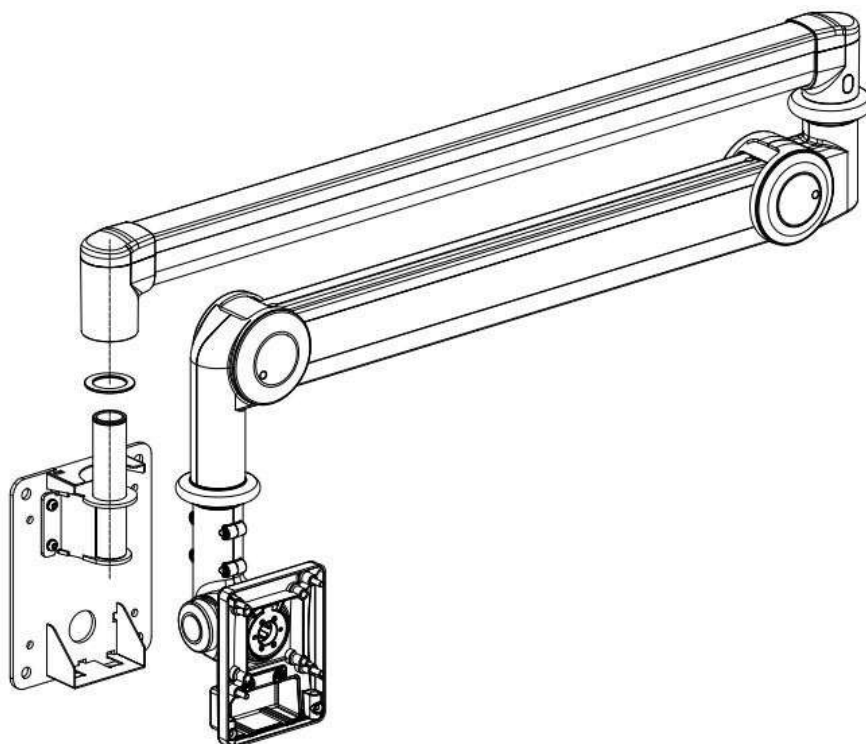

2. Plastic cover removal steps

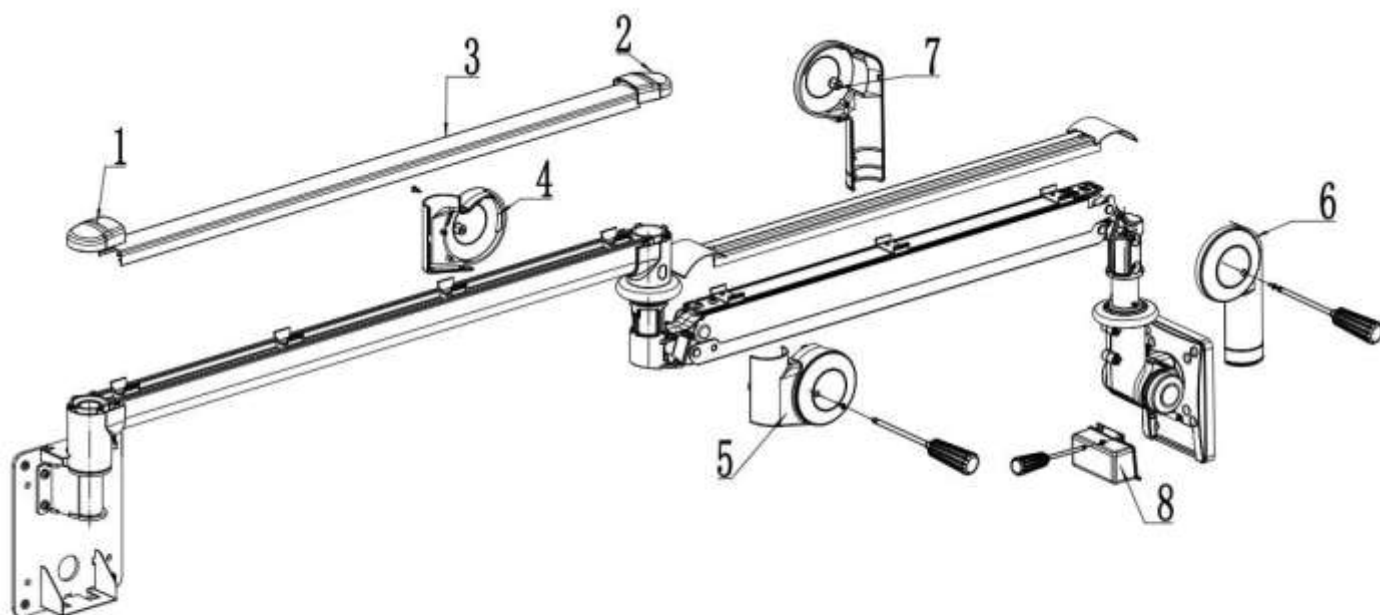

Remove the plastic covers in numerical order.

Accessory installation

支架内部穿线长度为2.2米

Length of wire inside the bracket 2.2 Meters

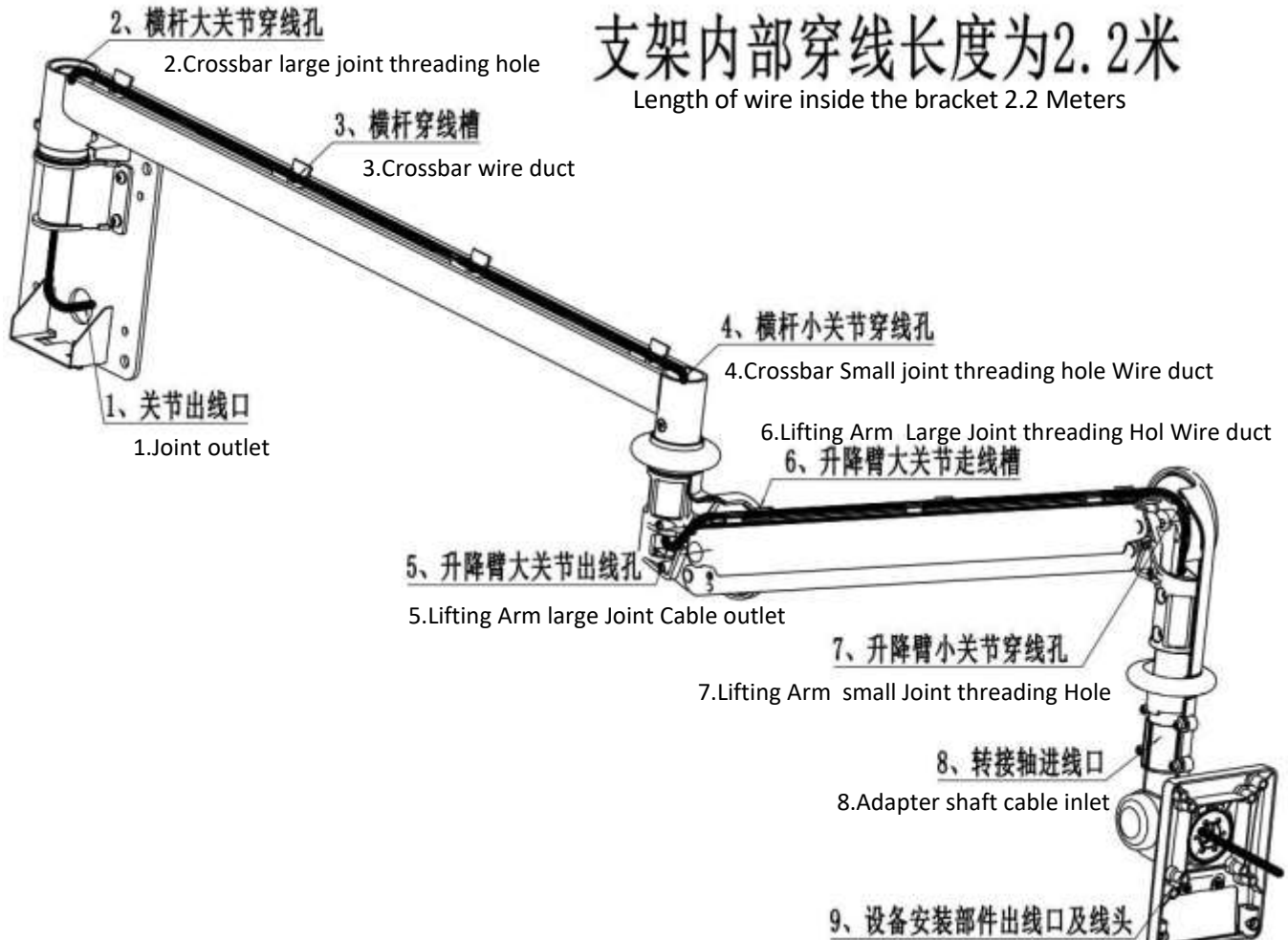

9. Equipment installation parts outlet and wire ends

Handle + display installation

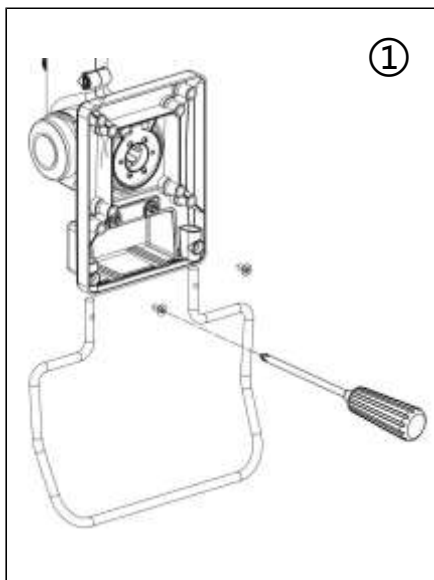

1. First, insert the fixed end of the handle into the reserved hole of the mounting plate as shown in the figure and align the fixing screw hole, then use the wrench shown in the figure to tighten the fixing screw.

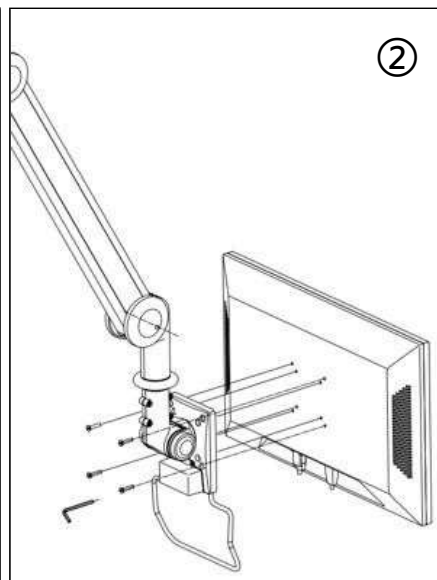

2. Use the M6*25 countersunk hexagon socket screws included in the accessory package to tighten the monitor in sequence.

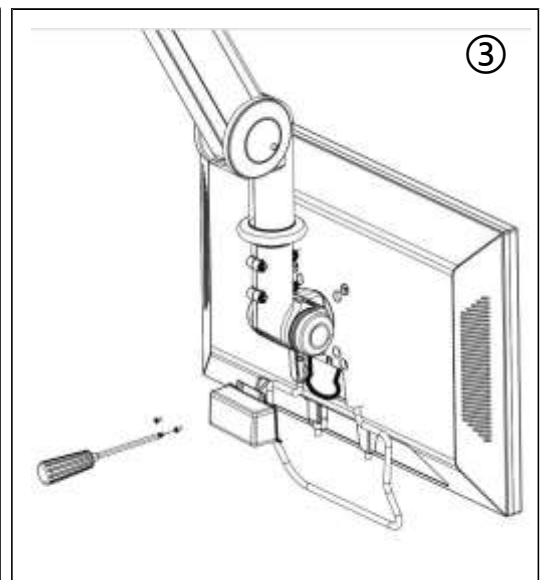

3. Open the wire storage box as shown in the figure, connect the data cable to the monitor, pull out the excess cable and straighten it, put it at the opening of the wire storage box, then buckle the junction box and tighten the fixing screws.

Rotation, pitch, and load-bearing adjustment

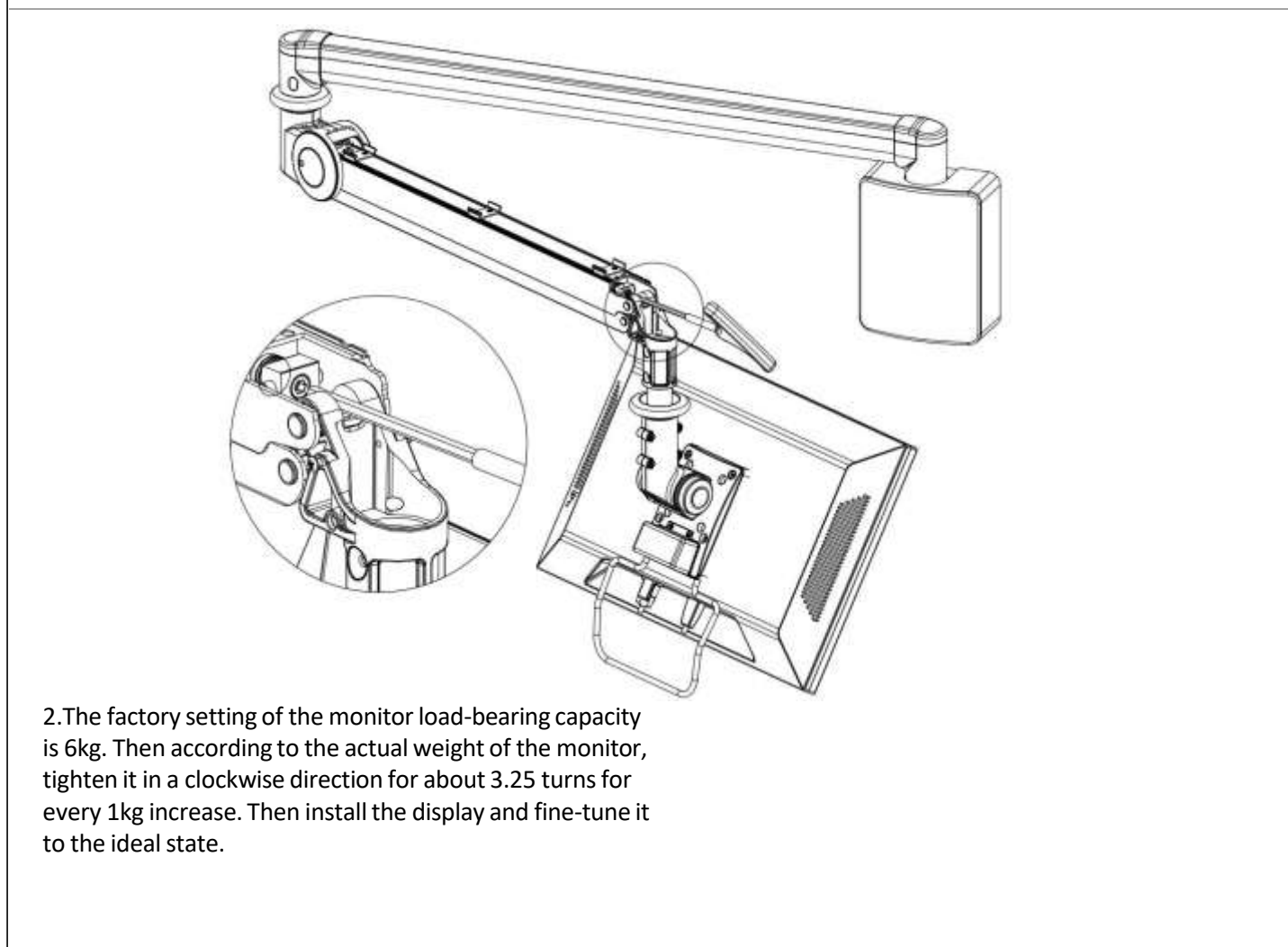
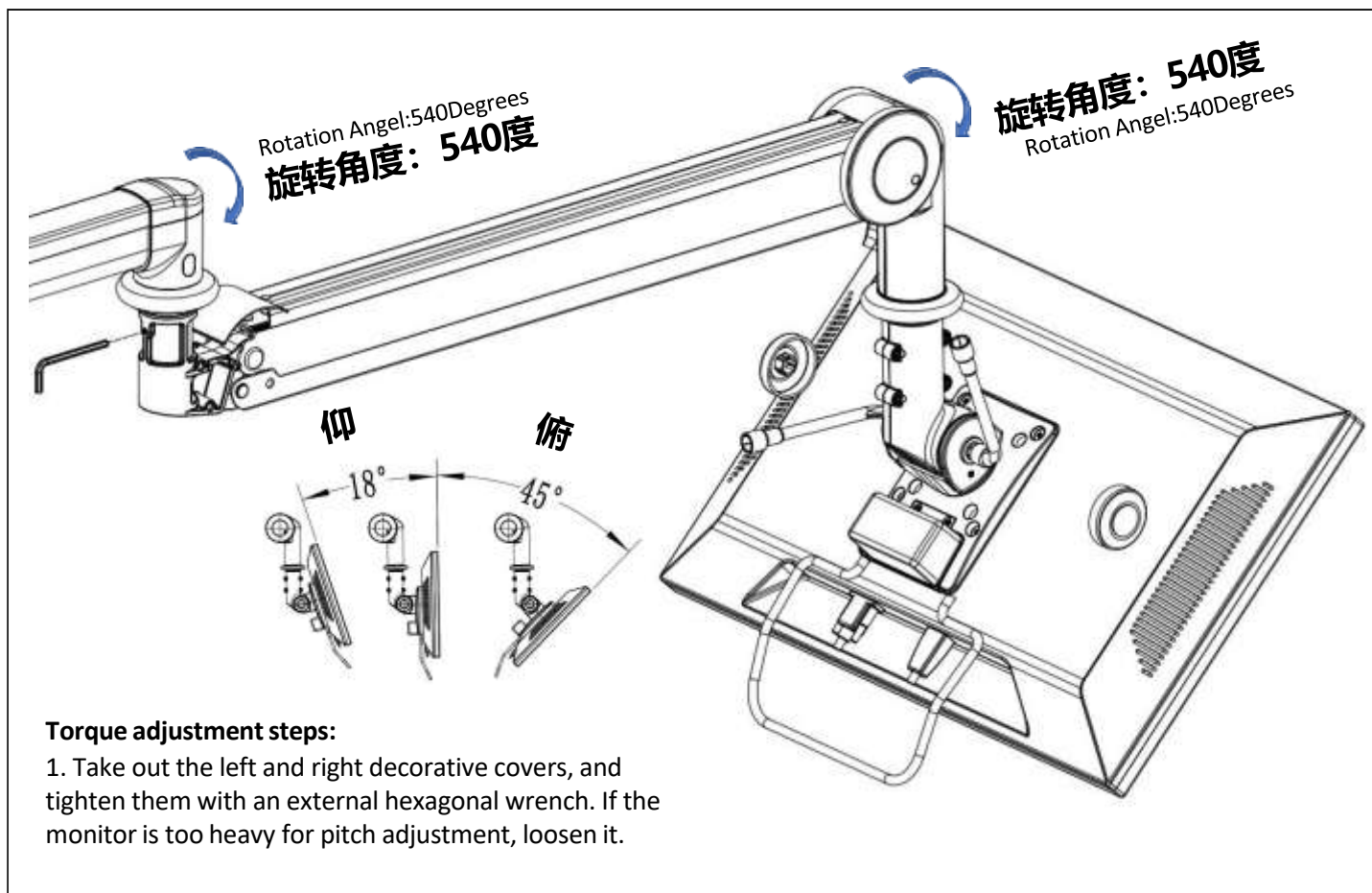

Safety precautions

Make sure it is fixed on a solid wall and can bear the weight of the bracket itself and the weight of the monitor;

Only monitors that meet this VESA standard (75*75/100*100) can be hung;

The lifting arm cannot be used to bear forces and objects other than the working monitor;

The load-bearing range of the PM-800 bracket is 1-8kg/6-14.5kg. Be sure to determine the actual weight of the monitor before purchasing the bracket;

The load-bearing capacity of the bracket is based on the center of gravity of the monitor being no more than 3 cm away from the end point of the VESA interface. If the monitor size is larger than 34 inches and the depth is greater than 6 cm, the load capacity may decrease;

The monitor bracket cannot be used for a long time in a strong acid, strong alkali, or humid environment, otherwise the actual service life of the bracket cannot be guaranteed.