

INSTALLTION INSTRUCTION

TMO-POS-006

Components:

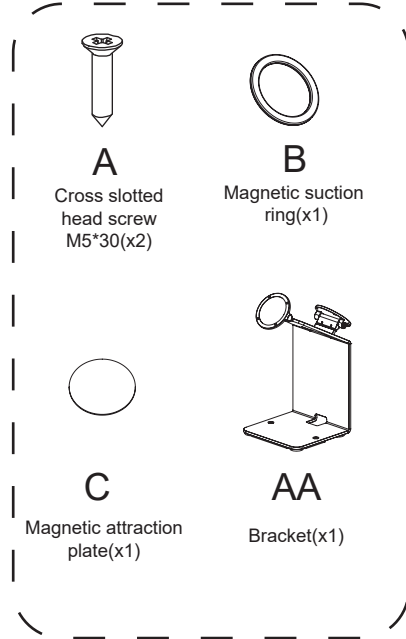

STEP1: Two fixing ways.

① If you don't need to lock it on the table, use it directly.

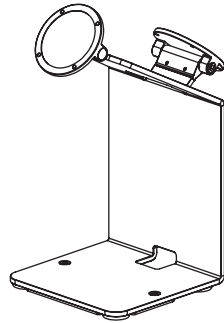

② If you need to lock it on the table, you need to first remove the counterweight plate and then fix it with screws.

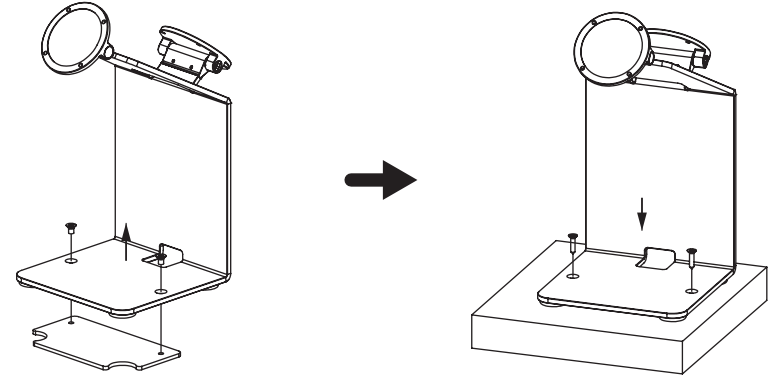

STEP2: Mount the tablet.

① Install magnetic attraction plate.

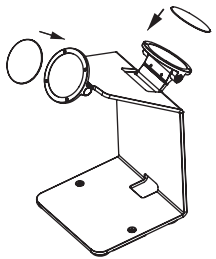

② Attach the magnetic suction ring to the flat plate.

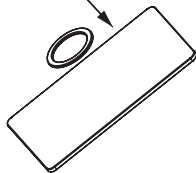

③ Place the tablet.

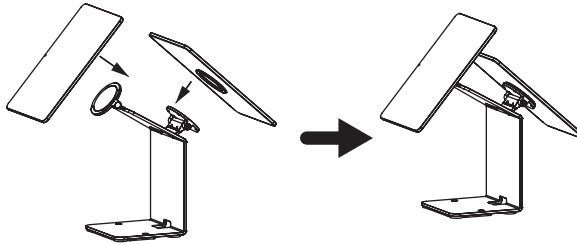

STEP3: Place the printer and organize the cables.

